

COMMON FEATURES

Media: water, oil, air
 Media temperature: $-10^{\circ}\text{C} \div +90^{\circ}\text{C}$
 Ambient temperature: $-10^{\circ}\text{C} \div +50^{\circ}\text{C}$
 Body material: brass (CW617N EN 12165)
 Operator material: stainless steel
 Operator seal material: FKM
 Main seal and diaphragm material: NBR
 Protection class: IP 65 (with connector and gasket)

OPTIONS

EPDM seal, temperature max. 120°C (e.g. code D188DEW)
 FKM seal, temperature max. 130°C (e.g. code C D189DVW)
 Electroless nickel plating treatment (e.g. code D190DBWK)
 NPT connection on request, minimum batch may be required (e.g. code D192DBWN)

DIMENSIONS & WEIGHTS		D187 C D187	D188 C D188	D189 C D189	D190 C D190	D192 C D192 compact	D293 C D293
G connection	[ISO 228]	1/4"	3/8"	1/2"	3/4"	1"	1"
A	[mm]	75	75	75	85	85	100
B	[mm]	108	108	108	108	108	113
C	[mm]	55	55	55	55	55	70
D	[mm]	14	14	14	21.5	21.5	21.5
weight	[kg]	0.5	0.5	0.5	0.8	0.7	1.2

VALVE	nominal Ø	flow rate Kvs	OPD			COILS AC only	
			min.	max. AC	max. DC	code	[Volts/Hz]
code	[mm]	[l/min]	[barg]	[barg]	[barg]	code	[Volts/Hz]
D187DBW	15	50	0	16	—	7200	24v 50/60Hz
D188DBW	15	60	0	16	—	7400	110v 50Hz - 120v 60Hz
D189DBW	15	65	0	16	—	7600	200v 50Hz - 220v 60Hz
D190DBW	15	80	0	16	—	7700	230v 50Hz - 240v 60Hz
D192DBW compact	15	85	0	16	—		
D293DBY	25	140	0	16	—		

VALVE	nominal Ø	flow rate Kvs	OPD			COILS DC only	
			min.	max. AC	max. DC	code	[Volts/Hz]
code	[mm]	[l/min]	[barg]	[barg]	[barg]	code	[Volts/Hz]
C D187DBW	15	50	0	—	6	7150	12v DC
C D188DBW	15	60	0	—	6	7250	24v DC
C D189DBW	15	65	0	—	6	7450	110v DC
C D190DBW	15	80	0	—	6	7750	230v DC
C D192DBW compact	15	85	0	—	6		
C D293DBY	25	140	0	—	3.5		

TYPE: D187 ÷ D192/293

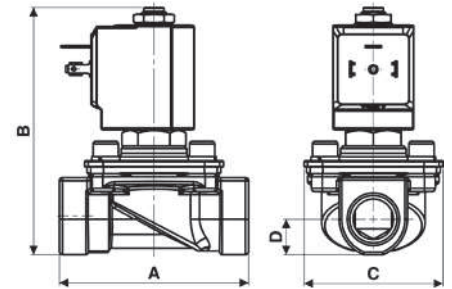
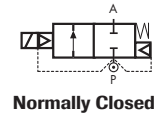

Flow direction overseat 1 → 2

D187 ÷ 192/293 - NBR seal, NC -

Coil power: AC 18va (holding)
 AC 36va (inrush)

OPTIONS

For vacuum see TIS *55 01*

NOTES

Speed control screw as standard for type D293

C D187 ÷ 192/293 - NBR seal, NC -

Coil power: DC 14w

NOTES

Speed control screw as standard for type C D293

